

## Product introduction

100X diaphragm type remote control float valve has many kinds of function and is installed at the inlet of pool or water tower, when the water-level reach the setting level, the main valve closes by the float pilot valve's control and stop supplying water; when the water-level comes down, the main valve opens by the float pilot valve's control and supply water to the pool. 100X remote control float valve can control the water-level of pool precisely and is not interrupted by the pressure. 100X remote control float valve can be installed freely according to the height of pool and using space. It is easy to maintain , to commission and to inspect. This kind of valve is reliable on sealing and it's life is very long. It is easy to maintain , to commission and to inspect. This kind of valve is reliable on sealing and it's life is very long. less. For Dn500mm or more , piston type valve is advised to be chosen.

## configuration drawing

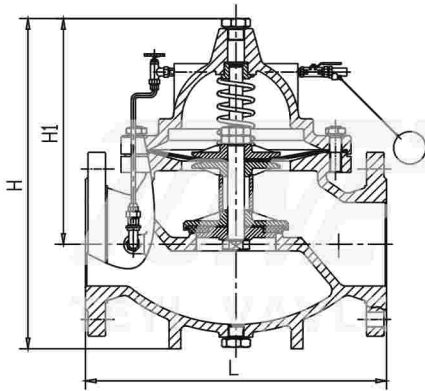

## Installation drawing

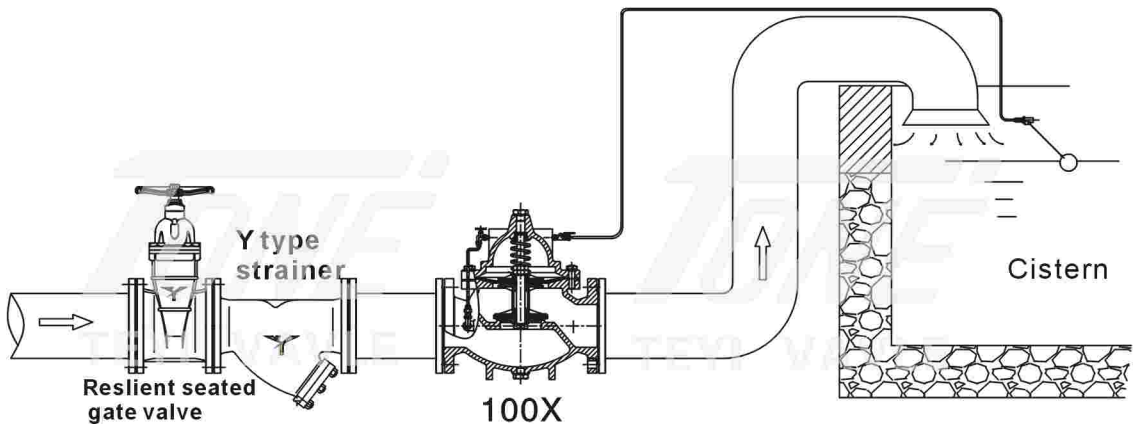

## Main Dimension

公称通径 DN ( mm )	50	65	80	100	125	150	200
L(mm)	230	250	241	292	330	356	495
H(mm)	270	305	320	400	455	502	636
H1(mm)	200	210	220	260	310	342	413
公称通径 DN ( mm )	250	300	350	400	450	500	600
L(mm)	622	698	787	900	978	1075	1230
H(mm)	750	913	913	1035	1035	1300	1370
H1(mm)	510	600	600	685	685	880	950